



29 Calder Drive, Worsley  
£375,000

# 29 Calder Drive

Worsley, Manchester

Millbrooke are delighted to offer for sale this immaculate property in a highly sought-after location, this three bedroom semi-detached is perfect for those looking for a spacious family home. Council Tax band: C

Tenure: Leasehold

EPC Energy Efficiency Rating: D

EPC Environmental Impact Rating:

- Popular Residential Area
- Immaculate Semi-Detached Property
- Three Double Bedrooms
- Two Bathrooms
- Open Plan Kitchen / Dining / Living Room
- Local Amenities Nearby
- Private Rear Garden
- Off Road Parking
- Converted Garage







# Calder Drive, Worsley

## Total Approx. Floor Area 1474 Sq.ft. (137.0 Sq.M.)

Surveyed and drawn by Lens Media for illustrative purposes only. Not to scale. Whilst every attempt was made to ensure the accuracy of the floor plan, all measurements are approximate and no responsibility is taken for any error.

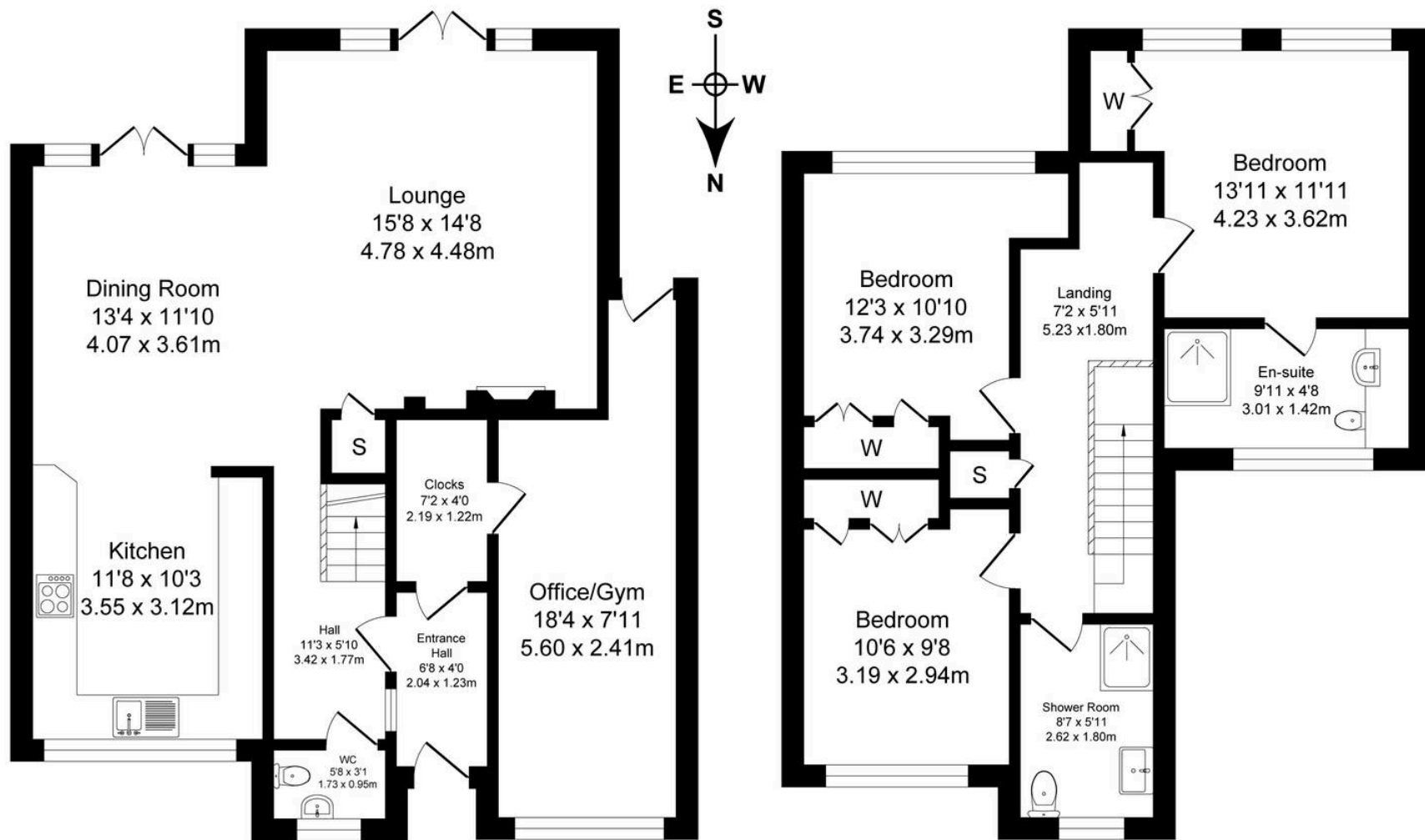

Ground Floor

Approx. Floor Area 835 Sq.Ft (77.6 Sq.M.)

First Floor

Approx. Floor Area 639 Sq.Ft (59.4 Sq.M.)



## Millbrooke Estate Agents

271 Mosley Common Road, Worsley, Manchester - M28 1BZ

0161 790 5154 • [hello@millbrooke.co](mailto:hello@millbrooke.co) • [millbrooke.co](http://millbrooke.co)

