

8 Ashley Drive, Swinton

In Excess of £450,000

8 Ashley Drive

Swinton, Manchester

Millbrooke Estate Agents are delighted to offer for sale this beautifully presented, extended three bedroom, semi-detached property located in a popular area of South Swinton.

Council Tax band: B

Tenure: Freehold

EPC Energy Efficiency Rating: G

EPC Environmental Impact Rating: F

- Stunning Extended Semi-Detached Property
- Immaculately Presented
- Fabulous Open-Plan Kitchen / Dining / Living Area
- High Quality Fitted Kitchen with Integrated Appliances
- Freehold Property
- Highly Desirable Location
- Excellent Transport Links
- Private Rear Garden
- Ample Off Street Parking
- Many Local Amenities







Ashley Drive, Swinton

Total Approx. Floor Area 1524 Sq.ft. (141.6 Sq.M.)

Surveyed and drawn by Lens Media for illustrative purposes only. Not to scale. Whilst every attempt was made to ensure the accuracy of the floor plan, all measurements are approximate and no responsibility is taken for any error.



Ground Floor

Approx. Floor
Area 1070 Sq.Ft
(99.4 Sq.M.)

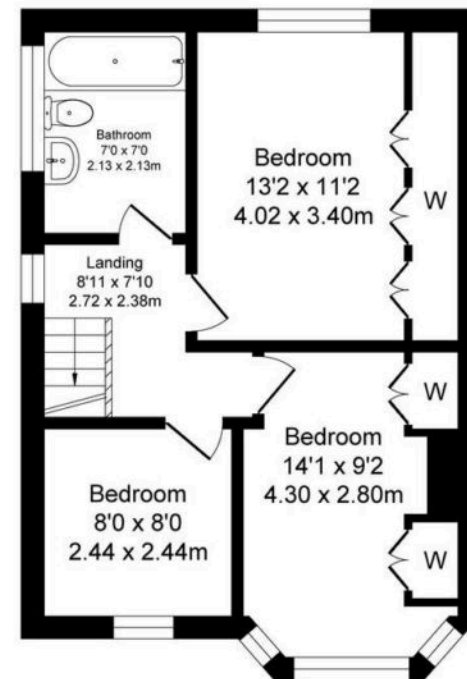

First Floor

Approx. Floor
Area 454 Sq.Ft
(42.2 Sq.M.)



Millbrooke Estate Agents

271 Mosley Common Road, Worsley, Manchester - M28 1BZ

0161 790 5154 • hello@millbrooke.co • millbrooke.co

